

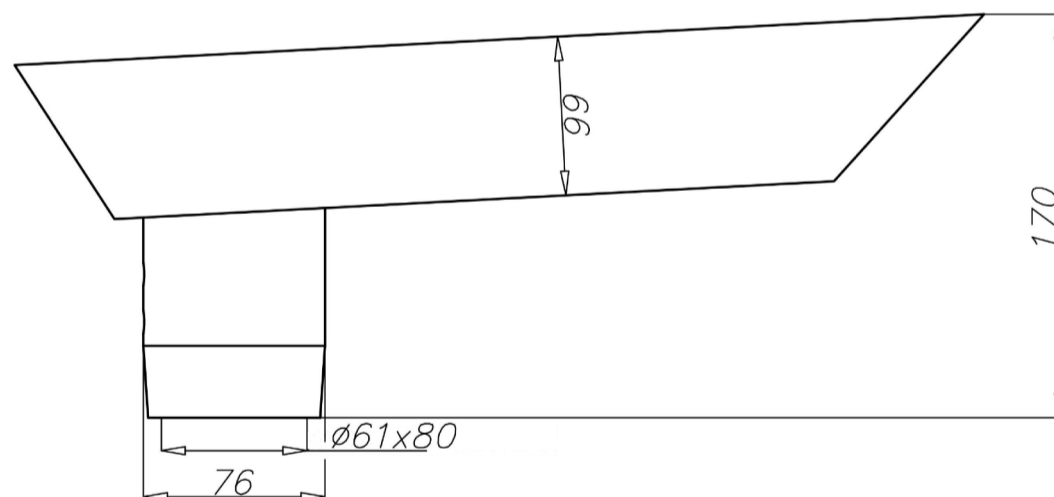

ISKRA LED ALFA

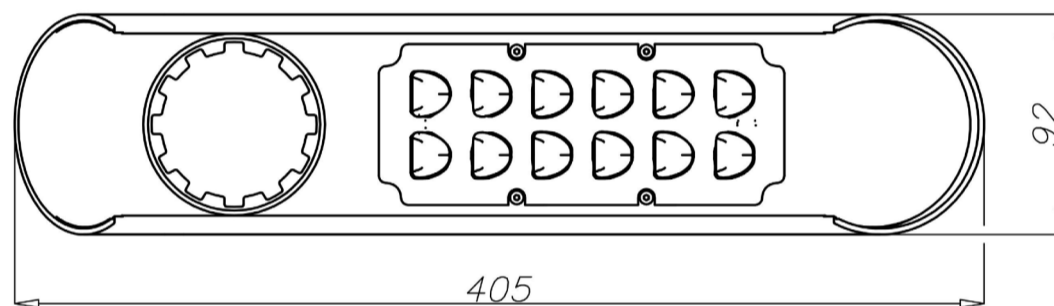

Characteristic

Ingress protection of optical system and driver	IP 66
Electrical class	II
Nominal input voltage	100 - 240 V AC
Frequency	50/60 Hz
Operating temperatures	-40°C to +55°C
Material	anodized aluminium alloy
Colour	inox / black
Setup	pole top mounted Ø60x80; recommended mount height 4 to 5 m
Optical system	PMMA lens
LEDs lifetime L90	>50 000h
Warranty	5 years





ISKRA LED ALFA



Technical parameters

Type	ISKRA LED ALFA 24		ISKRA LED ALFA 36	
Code	213330/6	213330/3	213332/6	213332/3
Correlated colour temperature [K]	5 000	3 500	5 000	3 500
Color rendering index CRI	75 ²⁾	>80	75 ²⁾	>80
LEDs type	CREE XT-E		CREE XM-L2	
LEDs quantity	12			
Supply current [mA]	760		960	
LEDs power [W]	24		36	
LEDs luminous flux ¹⁾ [lm]	3 100		5 100	4 150
Power consumption [W]	31		39	
Luminaire luminous flux ¹⁾ [lm]	2950		4 800	3 900
Luminaire efficacy [lm/W]	95		123	100
Weight [kg]	2,6			
Volume [m ³]	0,01			
Windage [m ²]	0,03			

- 1) including LEDs tolerance parameter accuracy +/- 3%
 2) parameter accuracy +/-2

- Low voltage directive LVD 2006/95/WE, norm PN-EN 60598-1, PN-EN 60598-2-3
- Directive EMC 2004/108/WE, norms: PN-EN 55015, PN-EN 61547, PN-EN 61000-3-2, PN-EN 61000-3-3
- Shown parameters based on measurements according to IESNA LM 79-08

Distribution of ISKRA LED ALFA

